



**INDIAN HEALTH SERVICE**

**SANITATION FACILITIES CONSTRUCTION PROGRAM OVERVIEW**

GREAT LAKES INDIAN HOUSING ASSOCIATION - OCTOBER 2021

### Sanitation Facilities Construction Program Overview

Provide technical and financial assistance to construct and maintain safe water, wastewater, and solid waste systems for Native American homes.



### Sanitation Facilities Construction Bemidji Area Office Locations

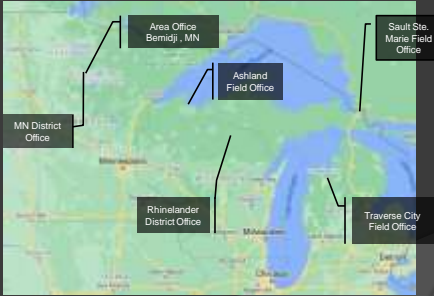

### Sanitation Facilities Construction Funding Sources



### Funding Sources

- 

**Regular Funds**
  - Intended for correcting deficiencies in existing water, sewer and solid waste facilities.
  - Allows design for future growth but there must be a deficiency. Not useable for new housing developments.
- 
**Housing Support Funds**
  - Intended to provide new and existing homes with water and wastewater facilities
  - Can be used to provide community facilities for housing developments

### Regular Funds

- Sanitation Deficiencies System (SDS)**
  - A list of deficiencies and proposed projects to correct the deficiencies.
  - Submitted to congress annually to determine funding level.
  - A scoring system prioritizes projects based on a number of factors including deficiency level, health impact and cost per home served.
  - Projects are funded in priority order until funding is exhausted.

### Community Water Systems



### Community Sewer Systems



### Solid Waste



### Regular Funds – Infrastructure Bill

- Major Investments in Indian Health Service's Sanitation Facilities Construction Program



Provides \$3.5 billion in technical and financial assistance to American Indian tribes and Alaska Native villages through IHS for cooperative development and construction of safe water, wastewater, and solid waste systems and related support facilities. This unprecedented investment in IHS sanitation will clear all known project needs.

### BAO Regular Funding History Not including \$7.4M ARPA in 2021

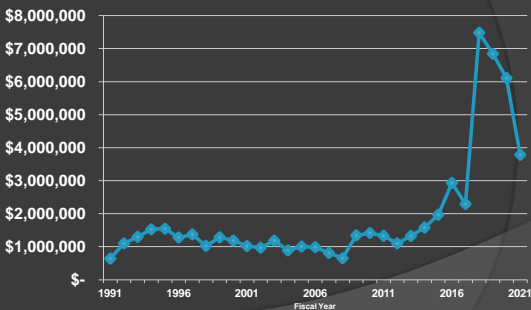

### EPA SDWA Funding History

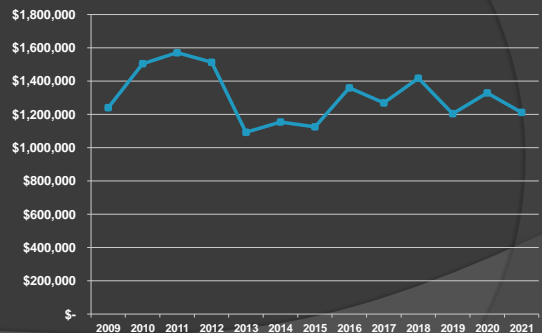

## EPA CWA Funding History

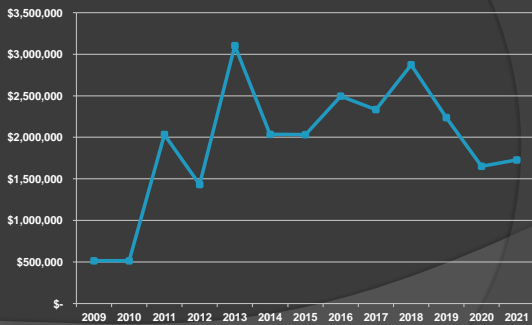

## Housing Funds

- Intended to provide individual homes with water and sewer facilities.

- Individual well and septic system

- Connection to existing water and sewer mains

- Extension of water and sewer mains to serve subdivisions or groups of homes



## Individual Water & Sewer



## Housing Funds

- Funds are allocated to each Tribe based on projected need using the Housing Priority System (HPS).
  - Each Tribe is contacted annually to determine the estimated funding need for the next year.
  - Funding need is submitted to HQ by August 31<sup>st</sup> of each year.
  - Funds are typically received and distributed the following spring.

## Housing Funds

- In recent years, sufficient funding has been available to serve all applicants across the Rhineland District.
- If funding for a particular Tribe is exhausted, "prior year" returned funds are usually available.

## Housing Funds - Eligibility

- Primary residence
- Located within the Tribe's service delivery area.
- Legal right to reside on the property
  - BIA Lease
  - Deed of ownership
- Homes built with HUD funding are not eligible
  - Homes renovated with HUD CDBG's are eligible

## Housing Funds – New Subdivisions

- Housing funds can be used for community water and sewer systems for new subdivisions
  - Homes must meet IHS eligibility requirements
  - Homes must be built within 4 years
  - Funding is limited to the IHS cost cap
    - \$54,500/home for water and sewer (Wisconsin)

Example: For a 12 home subdivision, the maximum IHS funding would be \$654,000.

## Housing Funds – Example Water and Sewer Main Extensions

- Keweenaw Bay – Acorn Trail Sewer Extension
  - Installing a sewage collection system with lift station to allow 35 existing septic systems to be abandoned.
- \$786,000 total cost
  - \$681,000 IHS
  - \$105,000 Tribal

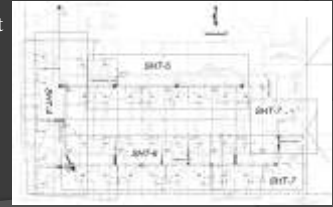

## Housing Funds - Example Water and Sewer Main Extensions

- Oneida – Beachtree Lane Subdivision
  - Extended water and sewer mains to serve 8 lots with water and sewer
- \$275,000 total cost
  - 100% IHS funds



## Housing Funds - Example New Subdivision

- Bay Mills – Plantation Hills Subdivision
  - Provide water extension and a new sewage system including treatment and disposal for a new 80 lot development
- \$4,500,000
  - \$4,000,000 USDA
  - \$500,000 IHS

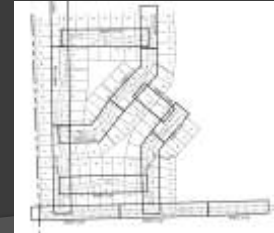

## Housing Funds - Example New Subdivision

- Lac Courte Orielles – Mandamin Subdivision
  - Provide extensions to the water and sewer systems to a new 34 lot subdivision.
    - IHS funding limited by the fact that only 4 homes are to be actually connected within the next few years.
- \$630,000
  - \$403,000 Tribe
  - \$227,000 IHS



## Housing Funds – New Subdivisions

- If planning a new subdivision, involve IHS early.
  - IHS can...
    - Provide input on subdivision layout relative to water and sewer design
    - Develop cost estimate for water and sewer facilities
    - Include costs in the annual HPS funding request

